

## METAL-ISO Ø9xL – ALU/ZINC STEEL – STAINLESS STEEL

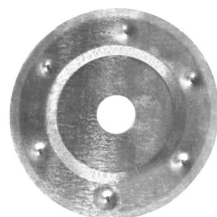

Washer Ø80



FIRE ≤ R240



Cap Ø43

### DEFINITION OF PRODUCT

- Metallic impact anchor.
- Hammered in or with METAL-ISO socket.
- Head Ø40 mm.
- Additional washer Ø80 mm.

### SCOPE OF APPLICATION

- Rigid insulation fastening.
- Flexible and semi-rigid insulation fastening with additional washer Ø80 mm.
- Anchor for concrete, aerated concrete and solid masonry.
- Various lengths available, up to 300 mm of insulation.
- Finishing cap.
- Painting possible on request.

### MATERIAL & FINISH

#### Material:

- Anchor and washer: steel DX51D – 1.0917 according to NF EN 10346.
- Anchor and washer: Austenitic stainless steel A2 (AISI 304) – 1.4301 according to NF EN 10088.
- Cap: Polyethylene.

#### Finish:

Aluminium/Zinc <sup>(1)</sup>

AZ150

Thickness ≥ 20 µm

<sup>(1)</sup> According to NF EN 10346

### INSTALLATION

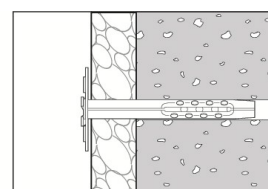
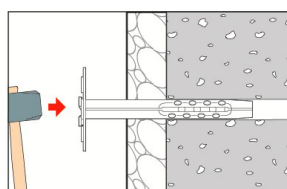
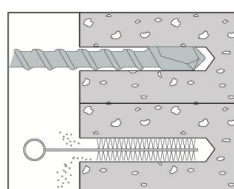

\*On-site testing

#### Additional products:

- METAL-ISO socket SDS+ (code: 343 540)
- Drill bits SDS+ Ø8 mm and Ø8.5 mm (refer to chapter "Tools" of anchor booklet)

## PERFORMANCES

Recommended loads  $F^{(\#)}$  :

METAL-ISO IN CONCRETE			Ø9
(Hammer drilling)	$h_{nom}$	(mm)	50
Concrete $\geq$ C20/25 - NF EN 206+A2	F	(daN)	28
METAL-ISO IN SOLID BLOCK			Ø9
(Hammer drilling)	$h_{nom}$	(mm)	50
Solid block - NF EN 771-3	F	(daN)	25
METAL-ISO IN SOLID BRICK			Ø9
(Hammer drilling)	$h_{nom}$	(mm)	50
Solid brick - NF EN 771-1	F	(daN)	21
METAL-ISO IN AERATED CONCRETE			Ø9
(Without drilling)	$h_{nom}$	(mm)	50
Aerated concrete - NF EN 771-4	F	(daN)	19.5

(#)  $F = F_1 / \gamma_M$  with  $\gamma_M = 4,0$  ;  $F = F_{Rd} / \gamma_{Mc}$  with  $\gamma_{Mc} = 1,4$

$F_1$ : Average of laboratory tests made by LR ETANCO -  $F_{Rd}$ : Ultimate load or design -  $\gamma_M$  et  $\gamma_{Mc}$ : Partial safety factors

## Fire reaction:

Object : Fire resistance test of ceiling protection products and their fasteners on concrete work.

## ROCKWOOL :

Product reference	System performance	Classification report	Thickness (mm)	Panel dimension (mm) Number of fastenings per panel
Formwork bottom" range - « ROCKFEU System / System dB and formwork »				
ROCKFEU System ROCKFEU System dB	REI 180	CSTB n° RS11/116B	80 to 200	2400 x 600 mm 6 integrated fasteners
ROCKFEU formwork	REI 240	CSTB n° RS11/116A	50 to 140	1200 x 600 mm 5 fasteners provide (50 mm) 8 fasteners provide (60 to 100 mm) 10 fasteners provide (110 to 140mm)
"Reported under Slab" range - « ROCKFEU REI RsD »				
ROCKFEU REI 60 RsD ROCKFEU REI 60 Natural RsD ROCKFEU REI 60 Black RsD	REI 60	CERIB n° 010251-e	60 to 300	1200 x 600 mm 5 fasteners
ROCKFEU REI 120 RsD ROCKFEU REI 120 Natural RsD ROCKFEU REI 120 Black RsD	REI 120	CERIB n° 010252-e	60 to 300	
ROCKFEU REI 240 RsD	REI 240	EFFECTIS n° 08-A8121 (60mm) EFFECTIS n° 12-A-606 (180mm)	60 to 180	

## HIRSCH ISOLATION :

Product reference	System performance	Classification report	Thickness (mm)
STISOLITH LR and LR A2	REI 120 thickness < 180 mm REI 120 thickness > 190 mm	EFR 18-004358 b	80 to 300 mm
STISOLITH ultra LR	REI 180	2016 CERIB 6722	80 to 310 mm
STISOLITH LR and LR A2	REI 120 thickness 80 and 90 mm REI 180 thickness 100 to 180 mm REI120 thickness 190 to 300 mm	EFR 18-004358 a	80 to 300 mm

Registration date: 12/07/2024 – Revision I

LR ETANCO is associate member of:



LR ETANCO - Parc les Érables - Bât. 1 - 66 Route de Sartrouville

78231 Le Pecq Cedex France - [www.etanco.eu](http://www.etanco.eu)

Tel : +33 (0)1 34 80 52 00 – [commercial.france@etanco.fr](mailto:commercial.france@etanco.fr)

## DIMENSIONS & CODES

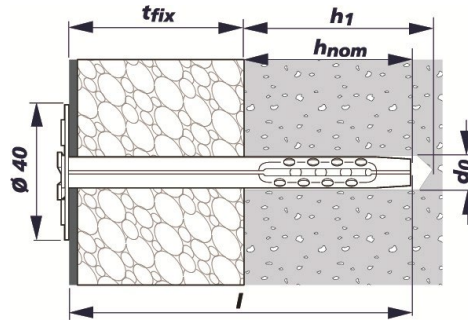

METAL-ISO	d <sub>0</sub> <sup>(*)</sup>	t <sub>fix</sub>	l	h <sub>1</sub>	h <sub>nom</sub>	h <sub>min</sub>	Code AZ150 steel	Code Stainless steel A2
9/10 X 60	8	10	60	60	50	100	343 510	-
9/30 X 80		30	80				343 500	343 520
9/50 X 100		50	100				343 519	-
9/60 X 110		60	110				343 502	343 522
9/70 X 120		70	120				343 507	-
9/90 X 140		90	140				343 504	343 524
9/100 X 150		100	150				343 509	343 525
9/110 X 160		110	160				343 531	-
9/120 X 170		120	170				343 506	343 526
9/130 X 180		130	180				343 523	-
9/140 X 190		140	190				343 538	-
9/150 X 200		150	200				343 508	343 528
9/170 X 220		170	220				343 521	-
9/180 X 230		180	230				343 515	-
9/190 X 240		190	240				343 529	-
9/200 X 250		200	250				343 517	-
9/220 X 270		220	270				343 533	-
9/230 X 280		230	280				343 530	-
9/250 X 300		250	300				343 518	-
9/300 X 350		300	350				343 535	-

(\*) Without drilling in aerated concrete.

d<sub>0</sub>: diameter of drilling - t<sub>fix</sub>: maximum thickness of the element to be fixed - l: anchor length - h<sub>1</sub>: min depth support drilling - h<sub>nom</sub>: minimum installation depth - h<sub>min</sub>: min thickness support.

ADDITIONAL WASHER	Code AZ150 steel	Code Stainless steel A2
Ø80 mm	343 565	343 567

PLASTIC CAP	Code White RAL 9010	Code Beige RAL 1015	Code Grey RAL 7030
Ø43 mm	343 570 001	343 570 014	343 570 007
Other colour, on request			

## ACCORDANCE

- Fire class A1.
- Fire resistance up to 240 min according to EFECTIS report n°06-A-292, 07-A-039, 07-A-273, 08-A-121.

## MARKING & LABELLING

### METAL-ISO :

- On packaging: METAL-ISO AZ150 9 + Length + CODE.
- On packaging: METAL-ISO InA2 9 + Length + CODE.

### ADDITIONAL WASHER Ø80 :

- On packaging: METAL-ISO WASHER AZ150 Ø80 + CODE.
- On packaging: METAL-ISO WASHER INA2 Ø80 + CODE.

### CAP Ø43 :

- On packaging: METAL-ISO CAP PE + Colour + CODE.

## QUALITY CONTROL

- ISO 9001 certified quality management system according to the certificate in force.

## NOTA

These products are intended for professional installers landlords whose the related service includes supply and installation. In accordance with rules and normative regulation, it's their responsibility to check that the use of these products is in conformity to themselves needs and their customers. They have to insure as well the adequacy of this material with their real operating conditions. The company excludes any guarantee for the use that does not respect these conditions. His responsibility is limited to the strict compliance with the specifications stipulated on the customer's purchase order. The guarantee is limited to the replacement of defective parts acknowledged by the Company's technical service, without workforce costs and travel expenses. It excludes material damage or physical injury and others direct or indirect damages, material or immaterial, which may result from defective parts including installation that not complying with the use for which they are designed and produced.

Registration date: 12/07/2024 – Revision I

LR ETANCO is associate member of:



LR ETANCO - Parc les Érables - Bât. 1 - 66 Route de Sartrouville  
78231 Le Pecq Cedex France - [www.etanco.eu](http://www.etanco.eu)

Tel : +33 (0)1 34 80 52 00 – [commercial.france@etanco.fr](mailto:commercial.france@etanco.fr)